

ROWTON

Apartment 50 2 Bedroom, Second Floor



ENTERPRISE
RETIREMENT
LIVING

BOUGHTON
HALL



Kitchen	2.40 x 3.23m	7' 10" x 10' 7"
Lounge/dining	3.61 x 5.67m	11' 10" x 18' 7"
Bedroom 1	3.61 x 5.20m	11' 10" x 17' 1"
Bedroom 2	2.88 x 4.44m	9' 5" x 14' 7"
Approx gross internal area	77 m²	830 ft²

Plans are not shown to scale and room dimensions are approximate, given at their maximum and are indicative only. They are not intended to be used for carpet sizes, appliance sizes or items of furniture. Furniture not included.

ROWTON

Second floor

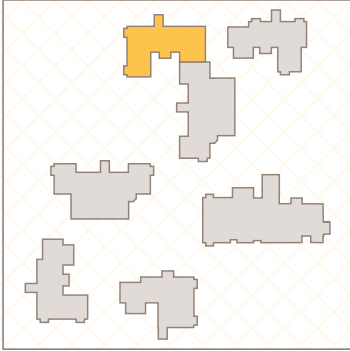

ENTERPRISE
RETIREMENT
LIVING

BOUGHTON
HALL



Plans are not shown to scale and room dimensions are approximate, given at their maximum and are indicative only. They are not intended to be used for carpet sizes, appliance sizes or items of furniture. Furniture not included.

SITE PLAN

ENTERPRISE
RETIREMENT
LIVING

BOUGHTON
HALL

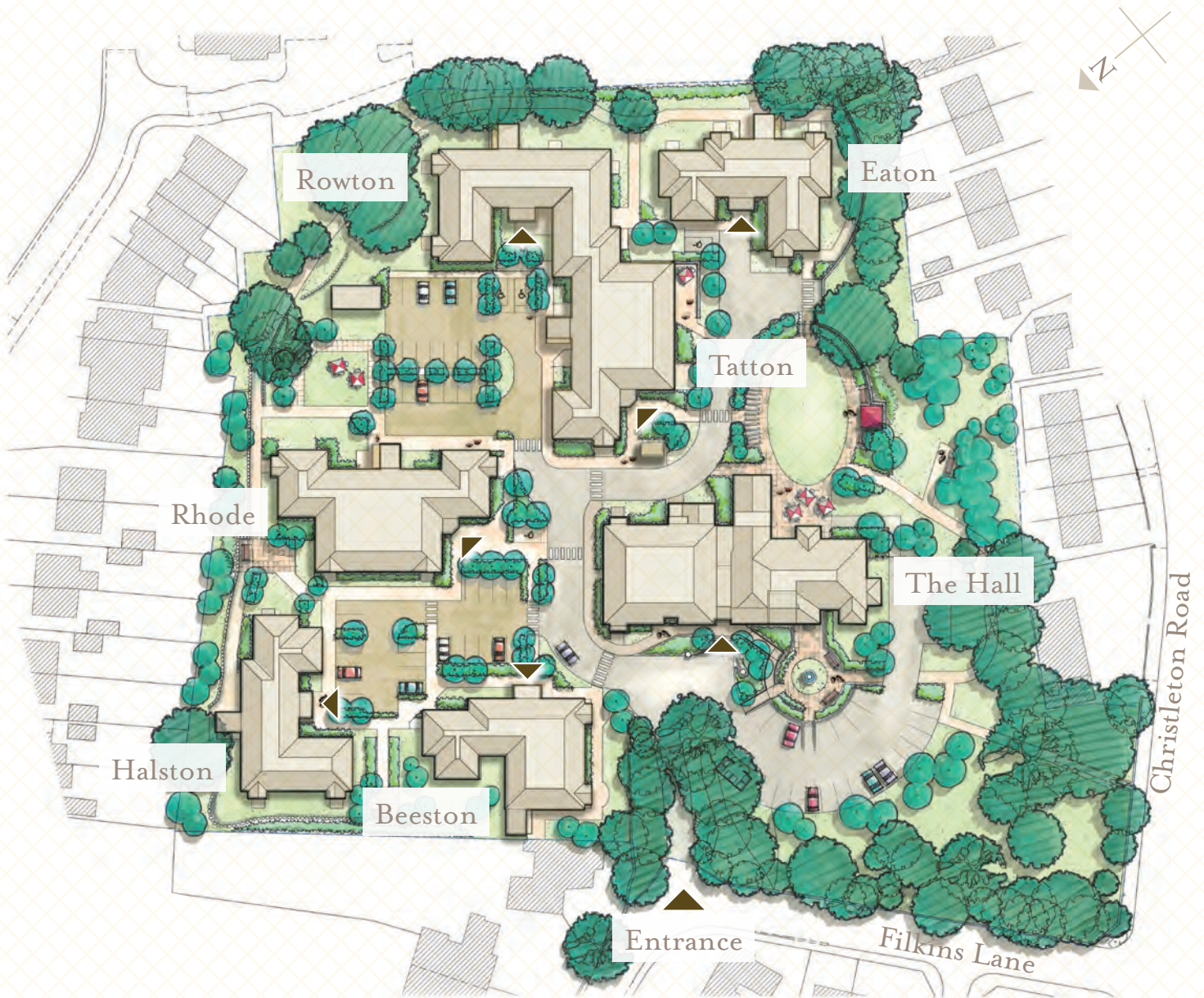

Whilst we try to be as accurate as possible, room dimensions are maximum and indicative. Layouts are not shown to scale and have been 'handed' in some cases for illustration purposes. Note: All ground floor apartments have patio doors. Plans include indicative furniture layouts and for the avoidance of doubt such furniture is not included within the specification.